

July 10, 1987
2322B:SM:m1s

INTRODUCED BY

BRUCE LAING
GARY GRANT

PROPOSED NO.

87-530

ORDINANCE NO. 8177

AN ORDINANCE amending the Local Service Area maps of the Sewerage General Plan that designate areas within King County eligible to receive sewer service.

THE KING COUNTY COUNCIL HEREBY MAKES THE FOLLOWING LEGISLATIVE FINDINGS:

1. The King County Sewerage General Plan was intended to coordinate the provision of sewer services with land use plans of the county. The principal tool for accomplishing this objective is the designation of specific geographical areas known as Local Service Areas (LSA). The LSD is updated and expanded through the adoption of community plans and community plan updates and a boundary adjustment process.
2. The 1985 King County Comprehensive Plan adopted the King County Sewerage General Plan as a functional plan and amended the substantive criteria for providing for boundary changes and expansions of local service areas. These boundary changes and expansions are now governed by the King County Comprehensive Plan policy F-316.
3. The transition area designation under the Comprehensive Plan generally applied to lands that are physically suitable for either urban or rural development and which currently have very low service and development levels.
4. A portion of an area lying within the transition area known as Hollywood in the North Shore Community Planning Area of King County (shown on the map in attachment A) already possesses detailed land use plans and zoning for urban uses and densities (BN & RM 3600).
5. The council also recognizes that the land is adjacent to existing local service area boundaries and its existing permitted commercial and residential uses require sewer service to provide effective and safe disposal of sewage.
6. Furthermore, council finds: providing sewer services to the area shown on Attachment A is wholly consistent with each of the six substantive criteria required in Comprehensive Plan policy F-316, and a local service area boundary change will not promote a need for zoning or land use changes nor serve as a precedent for any other change.
7. Based on the above findings, therefore, King County finds it appropriate to correct the omission from currently adopted LSA map.

BE IT ORDAINED BY THE COUNCIL OF KING COUNTY:

SECTION 1. Notwithstanding any other provision or policy to

1 the contrary, the local service area maps of the King County
 2 Sewerage General Plan are hereby amended to include a portion of
 3 an area known as Hollywood described as follows:

4 The east 388 feet of the south 180 feet of Section 15,
 5 Township 26, Range 5E; and the west 297 feet of the south 472
 6 feet of Section 14, Township 26, Range 5E; and the north 1,300
 7 feet of that portion of the section lying east of the
 8 Sammamish River of Section 22, Township 26, Range 5E; and

9 Lot 37, excluding the south 90 feet, and the west 201 feet of
 10 lot one of Hollywood Acres.

11 SECTION 2. Sewer lines in the above described area shall be
 12 sized only to serve existing neighborhood business zoned
 13 properties within this expansion area.

14 SECTION 3. A map of the boundaries is attached and hereby
 15 made a part of this ordinance.

16 INTRODUCED AND READ for the first time this 20th day
 17 of July, 1987.

18 PASSED this 10th day of August, 1987

19 KING COUNTY COUNCIL
 20 KING COUNTY, WASHINGTON

21 Gary Grant
 22 Chair

23 ATTEST:

24 Geraldine Polun
 25 Deputy Clerk of the Council

26 APPROVED this 20th day of August, 1987

27 Rue Fath
 28 King County Executive

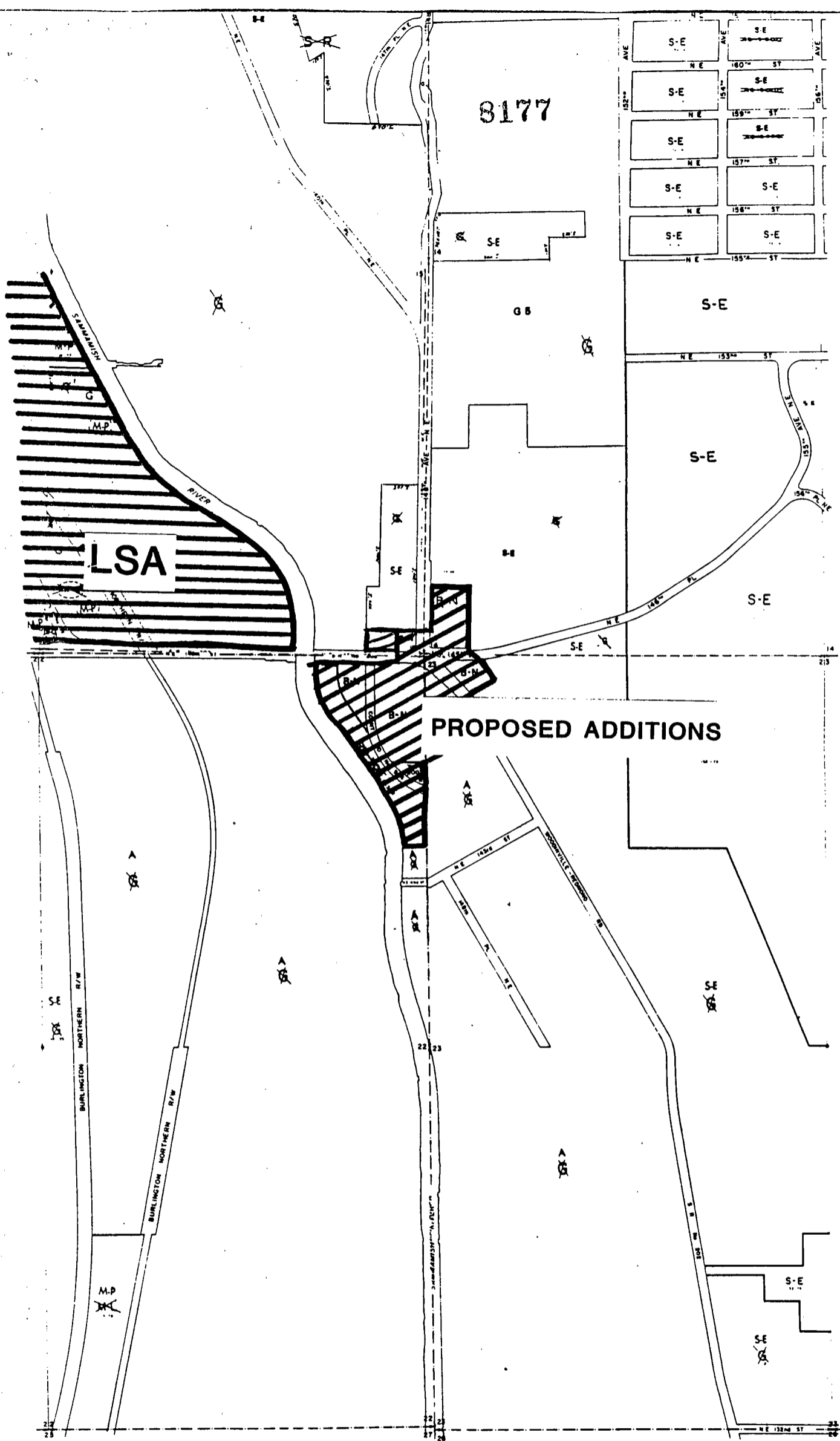

8177

LSA

PROPOSED ADDITIONS

E22-26N23-26-5

WOODINVILLE